

# THE PROFESSIONALS.

Professional fire protection and smoke control doors

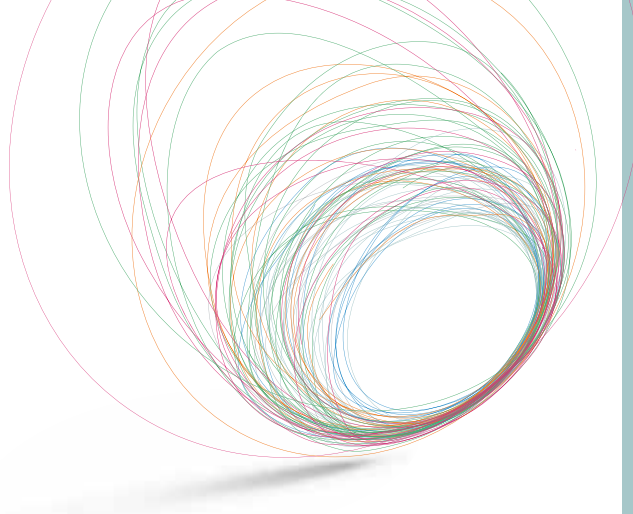



## **Performance promise and service standards**

Design | Security | Service Pages 04 - 11

## **Fire protection doors**

**Fire protection doors T30/T60/T90** **Pages 12 - 13**

T30 "HT 8-D" Pages 14 - 15

T30-1/2-FSA "Teckentrup 42" Pages 16 - 17

**62er modular system** **Pages 18 - 19**

T30-1/2-FSA "Teckentrup DF" (thick rebate) Pages 20 - 21

T30-1/2-FSA "Teckentrup 62" Pages 22 - 23

T30-1/2-FSA "Teckentrup 62 AE" (outdoor) Pages 24 - 25

T30-1/2-FSA "Teckentrup 62 ST" (flush) Pages 26 - 27

T30-1/2-FSA "Teckentrup GL" (all-glass) Pages 28 - 31

T60-1/2-FSA "Teckentrup 62" Pages 32 - 33

T90-1/2-FSA "Teckentrup 62" Pages 34 - 35

T90-1/2-FSA "Teckentrup 62 AE" (outdoor) Pages 36 - 37

T90-1/2-FSA "Teckentrup DF" (thick rebate) Pages 38 - 39

## **Smoke protection doors**

**Smoke protection doors** **Pages 40 - 41**

RS-1/2 "Teckentrup 62" Pages 42 - 43

## **Design variety**

For your individual demands Pages 44 - 49

## **Safety aspects**

Safety and accessories Pages 50 - 65

Technical data Pages 66 - 67

MADE  
IN  
GERMANY



# TECKENTRUP DOOR SOLUTIONS

Whether it's development, production or distribution, whether it's about the entire whole or about a small detail, for us, everything revolves around the decisive question: **WHAT IS THE SOLUTION FOR YOU?**

Because we are the specialist for fire protection, smoke protection, sound insulation and security doors, for industrial sectional doors, rolling shutters, folding doors, sliding doors and garage doors.

And we are **"Made in Germany"**. For more than 80 years, we have developed and produced our products exclusively in Germany. More than 900 employees at our locations in Verl and Großzöberitz create our high-quality products for you. All processes, from supply to production to commissioning and delivery, are based on the DIN EN ISO 9001 quality management system.

DESIGN

SECURITY

SERVICE

Teckentrup produces more than doors and gates: Teckentrup delivers solutions. Which is why we have applied three new standards to our company and our products which meet your needs: Design. Security. Service.



**Design:** We link functionality and aesthetics.

Because good design represents innovative technology that meets the needs of the user. Our products are opening new worlds and offer many individual design options. With us, designers and engineers work hand-in-hand from the beginning. So that intelligent ideas are just as convincing at the second glance and sophisticated designs prove themselves day after day.



**Security:** We link systems to protection.

Our doors meet the highest requirements and are certified accordingly. We are happy to advise you on necessary standards and develop comprehensive needs-oriented safety approaches in order to protect people and valuables.



**Service:** We link speed to reliability.

Proximity, clear structures, everything from one source. This is the service advantage of Teckentrup. Because, from product development to installation, from the committed support of our expert advisers to professional servicing: we will be there for you right away. We are happy to make the time.



# BUILDING EXPERTISE FROM ONE SOURCE

Large construction projects are faced with enormous cost pressure. This is why all of our products are embedded in an approach for process optimisation. We count on holistic service – from planning to installation to operating our folding doors. We can support you with consultation and planning services, we provide just-in-time deliveries if required, we place great emphasis on easy installation and we are also there to help you at any time during the construction phase by providing solutions at short notice. Therefore, you can rest assured that you receive the right solution for all of your property's requirements.

---

## OUR SERVICES FOR YOU

Secure clear efficiency advantages for yourself in every project phase:

- Comprehensive property and project advising for each of your projects
- Standardised technological platform with sophisticated installation materials
- Tender documents and technical drawings to develop your tender

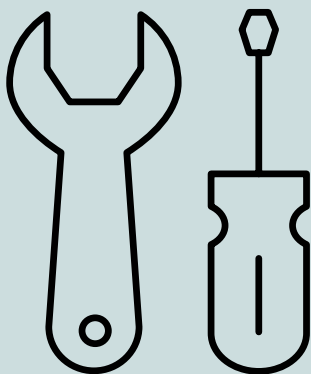

More information at [www.teckentrup.biz](http://www.teckentrup.biz)

# PROFESSIONAL PRODUCTS IN EVERY DETAIL

**You will know the situation as a professional project manager: Whether the project turns out to be a great success often depends on minute details. Got to know that you can rely on our comprehensively designed door solutions. For instance, when it comes to accessories, components and supplemental modules.**

In serial production at Teckentrup: Extra advise ex works: Whether it is door handles, lock and escape route technology, hinges and security bolts, door closers or electronic attachments - our employees are happy to support you select and configure the optimal components at any time. It goes without saying that this also applies for the selection of the colours, surfaces and glazing. The result is a comprehensive systematic solution for your project in which all pieces perfectly fit.







# COMPREHENSIVE SERVICE

**We provide custom solutions and comprehensive service to our customers, from project planning to installation to operating our doors. Take a look for yourself.**

## **COLDITZ CASTLE**

Colditz castle in the heart of Saxony is one of the most beautiful 16th century buildings in Central Germany. Today, it is a museum, a venue for concerts and events, home to the State Music Academy of Saxony and a youth hostel.

With the comprehensive refurbishment from 1997 to 2005, not only fire protection requirements were fulfilled, but the planners also found extremely discreet solutions in harmony with the building's listed status. For example, many of the passageways have been fitted with TeckentrupT30 all-glass doors, which combine functionality with aesthetics and maximum transparency. They combine modern fire-protection with demanding aesthetic requirements and blend discreetly into the background.





## PS.SPEICHER EINBECK

The former granary built in 1898 was unused for many years, until the Kulturstiftung Kornhaus had it restored in 2009. The task was to give the 6,500 sqm of the granary a contemporary design without losing its historic charm. The result is premises with a combination of cool, elegant steel and warm, cosy wooden elements for the approx. 300 exhibits from the 130-year history of the two-, three- and four-wheeled vehicles.

Teckentrup oversaw the security concept of PS.Speicher. Special doors made from steel with burglary, fire and in some cases also smoke prevention are used, as was the double-leaf steel door T90-2 'Teckentrup SV', which protects against fire, smoke and burglary, is also sound-proofed and serves as a transition from the bistro to the exhibition room. With the Rost-Patina and the fittings, it fits perfectly in to the ambience as if it had always been part of the granary. All single- and double-leaf T90 multifunctional doors are certified in accordance with DIN 4102 (fire-resistant); furthermore, all monitoring and locking systems (e.g. the magnet contacts) of the doors are executed doubly.

# TECKENTRUP

# FIRE PROTECTION DOORS

In the event of fire, the primary goal is to protect people from the flames and prevent further spread of the fire.

Good to know that you can also benefit from our decades of experience in this area, too. Our fire protection doors, in addition to comprehensive licences in accordance with DIN -5 (verified in accordance with EN 1634-1), also hold certifications in accordance with EN 16034 for the European market. Our fire resistant doors thereby guarantee the life cycles required by the legislator and also meet the highest requirements in terms of aesthetics and burglary protection.



### **Benefits that convince**

- Improved fire protection
- Tested as per EN 1634-1
- T30, T60, T90
- Door leaf flush without protruding edges
- Faster installation and easier to close
- Height adjustable
- More safety, design and convenience

### **Uses:**

- Production plants
- Office buildings
- Hospitals / clinics
- Public facilities
- Large residential structures
- Large garages and schools
- Cultural buildings and cinemas
- Blocks of flats and detaches houses



T30/T60/T90 according to  
EN 1634-1/DIN 4102



**TECKENTRUP**  
DOOR SOLUTIONS



# FIRE-RESISTANT STEEL DOOR

## T30 'HT 8-D'

- SINGLE LEAF
- THICK REBATE
- NOW NEW: WITH EXPOSED MASONRY INSTALLATION
- FOR LEFT OR RIGHT HAND OPERATION
- FOR INDOOR USE

### Size range

Modular dimensions:

Width: 750 – 1,125 mm

Height: 875 – 2,125 mm

### Installation in

- Masonry, min. 115 mm
- Concrete, min. 100 mm

### Door leaf

- Double-leaf
- Door 4-leaf rebated (thin rebate)
- Door leaf thickness: 42 mm
- Panel thickness: 0.9 mm
- Security bolt: at least 1

### Surface

Door leaf and frame galvanised, powder-coated and primed; grey white like RAL 9002

### Frame

- Corner page, 4-leaf, 2,0 mm thick with circumferential seal (sound-insulated)
- Frame attached with exposed masonry installation
- Frame with floor recess (standard)

### Special frame equipment

Counter frame or circumferential frame

### Special equipment

- Prepared for escutcheon hardware
- Top door closer as per EN 1154
- Locks (panic locks)
- Electric door openers
- Lock control (bolt contact) installed



**Fire-resistant**  
as per EN 1634-1  
(DIN 4102)



**Smoke-proof**  
as per EN 1634-3/  
DIN 18095<sup>1)</sup>



**Sound-insulated**  
as per EN 10140/  
EN 717-1 up to  
RW 39 dB<sup>1)</sup>

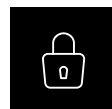

**Burglary-resistant**  
according to EN  
1627-WK2

**TECKENTRUP**  
DOOR SOLUTIONS

# SONDERAUSSTELLUNG

## KLEINST- UND KLEINWAGEN





# FIRE-RESISTANT STEEL DOOR

## T30-1/2-FSA "TECKENTRUP 42"

- 1- AND 2-LEAF
- THICK REBATE
- FLUSH DOOR LEAF WITHOUT HINGE STAMPING
- SERIAL FOR EXPOSED MASONRY INSTALLATION
- FOR INDOOR USE

### Size range

Modular dimension, 1-leaf:

Width: 625 – 1,125 mm

Height: 1 750 - 2 250 mm

Modular dimension, 2-leaf:

Width: 1,375 – 2,250 mm

Height: 1 750 - 2 250 mm

### Installation in

- Masonry, min. 115 mm
- Concrete, min. 100 mm
- Lightweight construction stud wall<sup>2)</sup>, min. 88 mm
- Autoclaved aerated concrete, min. 115 mm
- Clad steel and wooden supports F60

### Door leaf

- Double-wall, 3-leaf rebated (thin rebate)
- Door leaf thickness: 42 mm
- Panel thickness: 1.0 mm
- Security bolt: at least 1

### Surface

Door leaf and frame galvanised, powder-coated and primed; grey white like RAL 9002

### Frame

- Corner frame, 2.0 mm thick with 3-leaf seal
- Frame attached with exposed masonry installation
- Quantity: 3 pieces per side

### Special frame equipment

Counter frame, U frame or block frame

### Special equipment

- Prepared for escutcheon hardware
- Top door closer as per EN 1154
- Locks (panic locks)
- Electric door openers
- Arresting systems
- Bottom seals



**Fire-resistant**  
as per EN 1634-1  
(DIN 4102)



**Smoke-proof**  
as per EN 1634-3/  
DIN 18095<sup>1)</sup>

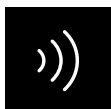

**Sound-insulated**  
as per EN 10140/  
EN 717-1 up to  
RW 38 dB<sup>1)</sup>

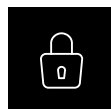

**Burglary-resistant**  
according to  
DIN EN 1627, WK 2<sup>1)</sup>



**ATEX**  
Directive  
2014/34 EU<sup>1)</sup>

**TECKENTRUP**  
DOOR SOLUTIONS



# SMART AND MODULAR

The modular system of the Teckentrup 62er doors.

## **Fives steps to your objective**

Our 62er modular system has 400,000 combinations for you. However, what is more important is that all of your needs are met: Your dream door. The path there is very simple. First, you define the application area and the associated functionality, such as fire protection. Then we move on to the checklist: How is the rebate to be structured? What type of wall are we working with? What frame best fits your spatial situation? And last but not least: What special equipment is desired?

# 3.

## Wall type

- Masonry
- Concrete
- Autoclaved aerated concrete
- Lightweight construction stud wall

# 4.

## Frame

- Corner frame
- Corner/counter frame
- Circumferential frame
- Block frame

# 2.

## Rebate form

- Thin rebate
- Thick rebate
- Flush-closing



# 5.

## Special equipment

- Glazing (round, rectangular)
- Upper casing
- Top light
- Stainless steel, etc.

# 1.

## Qualifications

- Fire protection T30, T60, T90
- Smoke-proof
- Sound-insulated up to 44 dB
- Burglary resistant RC2-RC4
- Heat insulation

As flexible as your needs: With our modular system, you configure step by step the doors desired for your property. In harmony with the architecture, for the purpose of use and in line with the technical circumstances on site. **Now also for outside use!**



# FIRE-RESISTANT STEEL DOOR

## T30-1/2-FSA "TECKENTRUP 62 DF" (THICK REBATE)

- 1- AND 2-LEAF
- THICK REBATE
- OPTIONALLY WITH GLAZING AND UPPER CASING
- ALSO IN STAINLESS STEEL
- FOR INDOOR USE

### Size range

Modular dimension, 1-leaf:

Width: 625 – 1350 mm

Height: 1 750 - 3 000 mm

Modular dimension, 2-leaf:

Width: 1,375 - 3,000 mm

Height: 1 750 - 3 000 mm

With upper casing height: 3 750 mm

### Installation in

- Masonry, min. 115 mm
- Concrete, min. 100 mm
- Lightweight construction stud wall<sup>2)</sup>, min. 88 mm
- Autoclaved aerated concrete, min. 115 mm
- Clad steel and wooden supports F60

### Door leaf

- Double-skinned, rebated on 3 sides with thick rebate
- Door leaf thickness: 62 mm
- Panel thickness: 1.0 mm or 1.5 mm
- Security bolt: per leaf at least 1

### Surface

Door leaf and frame galvanised and primed; grey white like RAL 9002

### Frame

- Corner frame, 1.5 / 2.0 mm
- 3-leaf with circumferential seal and lower floor bracket
- Frame attached with exposed masonry installation

### Special frame equipment

Counter frame, U frame or block frame

### Glazing

- Fire protection glass F30
- Glazing field rectangular with Aluminium glass retaining strips
- Max. pane dimensions 740 x 2,005 mm
- Round glazing Ø 300, 400, 500

### Special glazing equipment

- Steel glass retainer strips with additional aluminium cover strips, round glazing
- Glass retainer strips made from stainless steel

### Special equipment

- Prepared for escutcheon hardware
- Top door closer as per EN 1154
- Locks (panic locks)
- Secured drive deadlocks
- Swing door drives



**Fire-resistant**  
as per EN 1634-1  
(DIN 4102)



**Smoke-proof**  
as per EN 1634-3/  
DIN 18095<sup>1)</sup>

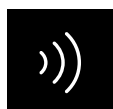

**Sound-insulated**  
as per EN 10140/  
EN 717-1 up to  
RW 40 dB<sup>1)</sup>

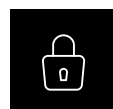

**Burglary-resistant**  
according to EN 1627,  
RC2 - RC3



**ATEX**  
Directive  
2014/34 EU<sup>1)</sup>

**TECKENTRUP**  
DOOR SOLUTIONS



# FIRE-RESISTANT STEEL CAP/STEEL DOOR

## T30-1/2-FSA "TECKENTRUP 62"

- 1- AND 2-LEAF
- THIN REBATE
- OPTIONALLY WITH GLAZING AND UPPER CASING
- ALSO IN STAINLESS STEEL
- FOR INDOOR USE

### Size range

Modular dimension, 1-leaf:

Width: 500 – 1500 mm

Height: 500 – 4000 mm

Modular dimension, 2-leaf:

Width: 1,375 – 3,000 mm

Height: 1 750 - 4 000 mm

With upper casing/top light: 4 600 mm

### Installation in

- Masonry, min. 115 mm
- Concrete, min. 100 mm
- Lightweight construction stud wall<sup>2)</sup>, min. 88 mm
- Autoclaved aerated concrete, min. 115 mm
- Clad steel and wooden supports F60

### Door leaf

- Double-leaf (thin rebate)
- Door 3-leaf rebated
- Hatch 4-leaf rebated
- Door leaf thickness: 62 mm
- Panel thickness: 1.0 mm or 1.5 mm
- Security bolt: per leaf at least 1

### Surface

Door leaf and frame galvanised, powder-coated and primed; grey white like RAL 9002

### Frame

- Corner frame, 1.5 / 2.0 mm thick
- Cap 4-leaf, door 3-leaf with circumferential seal
- Frame attached with exposed masonry installation

### Special frame equipment

Counter frame, U frame or block frame

### Glazing

- Fire protection glass F30
- With aluminium glass retainer strips, steel glass retainer strip galvanised and primed, grey white like RAL 9002
- Max. pane dimensions 904 x 2,150 mm
- Round glazing Ø 300, 400, 500

### Special equipment

- Prepared for escutcheon hardware
- Top door closer as per EN 1154
- Locks (panic locks)
- Electric door openers
- Lock control (bolt contact) installed
- Swing door drives



**Fire-resistant**  
as per EN 1634-1  
(DIN 4102)



**Smoke-proof**  
as per EN 1634-3/  
DIN 18095<sup>1)</sup>



**Sound-insulated**  
as per EN 10140/  
EN 717-1 up to  
RW 44 dB<sup>1)</sup>

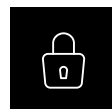

**Burglary-resistant**  
according to DIN EN 1627  
RC 2 - RC 4<sup>1)</sup>



**ATEX**  
Directive  
2014/34/EU<sup>1)</sup>

**TECKENTRUP**  
DOOR SOLUTIONS





# FIRE-RESISTANT DOOR FOR OUTDOOR USE

## T30-1/2-FSA "TECKENTRUP 62 AE"

- LICENSED FOR OUTDOOR APPLICATION
- $U_D = 1.3 \text{ W/M}^2\text{K}$  (1-LEAF) |  $U_D = 1.4 \text{ W/M}^2\text{K}$  (2-LEAF)
- 1- AND 2-LEAF
- FLUSH DOOR LEAF WITHOUT HINGE STAMPING

### Size range

Modular dimension, 1-leaf:

Width: 625 – 1350 mm  
Height: 1750 - 2500 mm

Modular dimension, 2-leaf:

Width: 1,375 – 2,500 mm  
Height: 1750 - 2500 mm

### Installation in

- Masonry, min. 175 mm
- Concrete, min. 100 mm
- Autoclaved aerated concrete, min. 150 mm

### Door leaf

- Standard opening outwards
- Double-skinned, rebated on three sides (thin rebate) with weatherboard
- Door leaf thickness: 62 mm
- Panel thickness: 0.75 mm
- Security bolt: at least 3

### Surface

Door leaf and frame galvanised, powder-coated and primed; grey white like RAL 9002

### Frame

- Corner frame, 1.5 mm thick, 3-leaf with circumferential seal and lower floor bracket and rain canopy (aluminium)
- Frame attached with exposed masonry without floor recess

### Special frame equipment

Counter frame, U frame or block frame

### Special equipment

- Locks (panic locks)
- Top door closer as per EN 1154  
Installation on hinge side / swing side, opening inwards or outwards
- Retractable bottom seal
- Lock control (bolt contact) installed
- Opening detector (Reed contact) installed
- Electromechanical blocking device
- Electric door openers
- RAL of your choice
- Multiple locking device



**Fire-resistant**  
as per EN 1634-1  
(DIN 4102)



**Use in outdoor walls**  
CE labelling as per EN  
14351-1

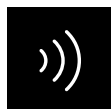

**Sound-insulated**  
as per EN 10140/  
EN 717-1 up to  
RW 33 dB<sup>1)</sup>

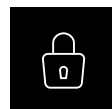

**Burglary-resistant**  
according to  
DIN EN 1627, RC 2<sup>1)</sup>



**ATEX**  
Directive  
2014/34/EU<sup>1)</sup>

**TECKENTRUP**  
DOOR SOLUTIONS



# FLUSH-CLOSING FIRE-RESISTANT DOOR

## T30-1/2-FSA "TECKENTRUP 62 ST"

- 1- AND 2-LEAF
- DOOR AND FRAME REBATE-FREE AND FLUSH WITH THE WALL SURFACE
- OPTIONALLY WITH GLAZING
- ALSO IN STAINLESS STEEL

### Size range

Modular dimension, 1-leaf:

Width: 625 – 1250 mm

Height: 1 750 - 2 500 mm

Modular dimension, 2-leaf:

Width: 1,375 – 2,500 mm

Height: 1 750 - 2 500 mm

### Installation in

- Masonry, min. 115 mm
- Concrete, min. 100 mm
- Lightweight construction stud wall<sup>2)</sup>, min. 88 mm
- Autoclaved aerated concrete, min. 115 mm
- Clad steel and wooden supports F60

### Door leaf

- Double-sheet, flush-closing
- Door leaf thickness: 62 mm
- Panel thickness: 1.0 mm
- Security bolt: per leaf 2
- Insulation: Mineral fibre board

### Surface

Door leaf and frame galvanised, powder-coated and primed; grey white like RAL 9002

### Frame

- Corner frame, 1.5 mm thick with 3-leaf circumferential seal
- Frame attached with exposed masonry installation

### Special frame equipment

Counter frame, U frame or block frame

### Glazing

- Fire protection glass F30
- With aluminium glass retaining strips
- Max. pane dimensions 741 x 1,658 mm
- Round glazing (stainless steel glass retaining strips) Ø 300, 400, 500 mm

### Special equipment

- Prepared for escutcheon hardware
- Top door closer as per EN 1154
- Locks (panic locks)
- Electric door openers
- Swing door drives
- Bottom seals can be retrofitted



**Fire-resistant**  
as per EN 1634-1  
(DIN 4102)



**Smoke-proof**  
according to EN 1634-3/  
DIN 18095 with OTS  
(only 1-leaf)<sup>1)</sup>



**Sound-insulated**  
as per EN 10140/EN  
717-1 up to max.  
RW 36 dB<sup>1)</sup>

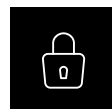

**Burglary-resistant**  
according to DIN EN  
1627, RC 2<sup>1)</sup>



**ATEX**  
Directive  
2014/34/EU<sup>1)</sup>

**TECKENTRUP**  
DOOR SOLUTIONS



The Teckentrup logo is presented in a bold, white, sans-serif font, centered within a solid black rectangular background.The title 'ALL GLASS DOORS' is written in a bold, white, sans-serif font, centered within a solid black rectangular background.

Transparency opens up spaces, creates broad views and communication, benefits flat hierarchies, brings brightness and lightness to contemporary architecture. We add a crucial plus point to these clear benefits:

---

## 100% FIRE PROTECTION

---

**Maximum transparency with 100% fire protection?** Teckentrup also offers you that. Our all glass door T30 is ex works fire-resistant in accordance with EN 1634-1/DIN 4102 and smoke-tight according to DIN 1634-3/DIN 18095. That makes its lean, reserved design with the elegant hardware made from stainless steel all the more fascinating.



# FIRE-RESISTANT ALL-GLASS DOOR

## T30-1/2-FSA "TECKENTRUP GL"

- 1- AND 2-LEAF
- FRAMELESS FIRE PROTECTION DOOR FOR MAXIMUM TRANSPARENCY
- HIGH-QUALITY, ELEGANT APPEARANCE
- 1-LEAF FULL GLASS DOOR ALSO SOUND-INSULATED

### Size range

Modular dimension, 1-leaf:

Width: 625 – 1250 mm

Height: 1750 – 2500 mm

Modular dimension, 2-leaf:

Width: 1,375 – 2,500 mm

Height: 1750 – 2500 mm

### Installation in

Modular dimension, 1-leaf:

- Masonry, min. 115 mm
- Concrete, min. 100 mm
- Lightweight construction stud wall<sup>2)</sup>, min. 100 mm
- Autoclaved aerated concrete, min. 115 mm

Modular dimension, 2-leaf:

- Masonry, min. 175 mm
- Concrete, min. 140 mm
- Autoclaved aerated concrete, min. 175 mm

### Door leaf

Door leaf thickness: 27 mm

### Surface

- Fitting covers stainless steel, 1.4301 240er corn polished
- Frame galvanised and powdercoated primed, traffic white like RAL 9016

### Frame

- Corner frame, 1.5 mm thick with 3-leaf seal and lower floor bracket
- Frame attached with exposed masonry installation

### Special frame equipment

- Counter frame, U frame or block frame
- Block frame type 4.1 and type 4.2

### Special equipment

- Film coating possible on the glass
- Door drive
- Anti-panic function
- Frame in RAL as desired or in stainless steel



**Fire-resistant**  
as per EN 1634-1  
(DIN 4102)



**Smoke-proof**  
as per EN 1634-3/  
DIN 18095<sup>1)</sup>



**Sound-insulated**  
according to EN 10140/  
EN 717-1 up to  
RW 34 dB<sup>1)</sup> (only 1-leaf)



**ATEX**  
Directive  
2014/34/EU<sup>1)</sup>

**TECKENTRUP**  
DOOR SOLUTIONS





# HIGHLY FIRE-RESISTANT DOOR

## T60-1/2-FSA "TECKENTRUP 62"

- 1- AND 2-LEAF
- THICK REBATE
- ALSO IN STAINLESS STEEL
- OPTIONALLY WITH GLAZING
- FOR INDOOR USE

### Size range

Modular dimension, 1-leaf:

Width: 625 – 1250 mm

Height: 650 – 2500 mm

Modular dimension, 2-leaf:

Width: 1,375 – 2,500 mm

Height: 1 750 - 2 500 mm

### Installation in

- Masonry, min. 115 mm
- Concrete, min. 100 mm
- Lightweight construction stud wall<sup>2)</sup>, min. 100 mm
- Autoclaved aerated concrete, min. 150 mm
- Clad F90 steel beams

### Door leaf

- Double-leaf
- Door 3-leaf rebated (thin rebate)
- Hatch 4-leaf rebated
- Door leaf thickness: 62 mm
- Panel thickness: 1.0 mm
- Security bolt: per leaf 2 – 3

### Surface

Door leaf and frame galvanised, powder-coated and primed; grey white like RAL 9002

### Frame

- Corner frame 1.5 mm thick with 3-leaf seal and lower floor bracket
- Frame attached with exposed masonry installation

### Special frame equipment

Counter frame, U frame or block frame

### Glazing

- Fire protection glass F60
- Glazing field rectangular with Aluminium glass retaining strips
- Max. pane dimensions 741 x 1,658 mm
- Round glazing Ø 300, 400, 500
- Steel glass retainer strip galvanised and primed; grey white like RAL 9002

### Special equipment

1-leaf:

- Prepared for escutcheon hardware
- Locks:
- Top door closer as per EN 1154
- For doors with glazing with OTS
- Secured drive deadlocks
- Electric door openers
- Lock control (bolt contact) installed
- Opening detector (Reed contact) installed
- Swing door drives
- Arresting systems

2-leaf:

- Additionally centre rebate seal



**Highly fire-resistant**  
as per EN 1634-1  
(DIN 4102)



**Smoke-proof**  
as per EN 1634-3/  
DIN 18095<sup>1)</sup>



**Sound-insulated**  
as per EN 10140/EN  
717-1 up to  
RW 33 dB<sup>1)</sup>

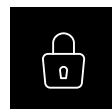

**Burglary-resistant**  
according to DIN EN  
1627 RC 2 - RC 3



**ATEX**  
Directive  
2014/34/EU<sup>1)</sup>

**TECKENTRUP**  
DOOR SOLUTIONS



bezahlen Sie Ihr  
Ticket an der  
Rezeption.  
Please pay your  
park ticket  
at the reception.

# FIRE-PROOF DOOR / FIRE-PROOF HATCH

## T90-1/2-FSA "TECKENTRUP 62"

- 1-AND 2-LEAF
- THICK REBATE
- ALSO IN STAINLESS STEEL
- OPTIONALLY WITH GLAZING
- FOR INDOOR USE

### Size range

Modular dimension, 1-leaf:

Width: 500 – 1500 mm

Height: 500 – 3000 mm

Modular dimension, 2-leaf:

Width: 1,375 – 3,000 mm

Height: 1 750 - 3 000 mm

With upper casing height; 4,000 mm

### Installation in

- Masonry, min. 175 mm
- Concrete, min. 140 mm
- Lightweight construction stud wall<sup>2)</sup>, min. 100 mm
- Autoclaved aerated concrete, min. 150 mm
- Clad F90 steel beams

### Door leaf

- Double-leaf
- Door 3-leaf rebated (thin rebate)
- Hatch 4-leaf rebated
- Door leaf thickness: 62 mm
- Panel thickness: 0.75 mm – 1.5 mm
- Security bolts: 3 or 4 per leaf

### Surface

Door leaf and frame galvanised, powder-coated and primed; grey white like RAL 9002

### Frame

- Corner frame, 1.5 mm thick
- Cap 4-leaf, door 3-leaf with circumferential seal and lower floor bracket
- Frame attached with exposed masonry installation

### Special frame equipment

Counter frame, U frame or block frame

### Glazing

- Fire protection glass F90
- With aluminium glass retaining strips
- Max. pane dimensions 1,000 x 2,263 mm
- Round glazing Ø 300, 400, 500 mm with steel glass retainer strip galvanised and primed; grey white like RAL 9002

### Special glazing equipment

- Steel glass retainer strips with additional aluminium covering strips
- Round glazing retainer strips in stainless steel

### Special equipment

- Prepared for escutcheon hardware
- Top door closer as per EN 1154
- Locks (panic locks)
- Swing door drives
- Bottom seals can be retrofitted



**Fire-proof**  
as per EN 1634-1  
(DIN 4102)



**Smoke-proof**  
as per EN 1634-3/  
DIN 18095<sup>1)</sup>



**Sound-insulated**  
as per EN 10140/  
EN 717-1 up to  
RW 42 dB<sup>1)</sup>

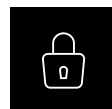

**Burglary-resistant**  
according to DIN EN  
1627, RC 2 - RC 4<sup>1)</sup>



**ATEX**  
Directive  
2014/34/EU<sup>1)</sup>

**TECKENTRUP**  
DOOR SOLUTIONS



# FIRE-PROOF DOOR

## T90-1/2-FSA "TECKENTRUP 62 AE"

- LICENSED FOR OUTDOOR APPLICATION
- $U_D = 1.3 \text{ W/m}^2\text{K}$  (1-leaf) |  $U_D = 1.4 \text{ W/m}^2\text{K}$  (2-leaf)
- 1- AND 2-LEAF
- FLUSH DOOR LEAF WITHOUT HINGE STAMPING
- SERIAL FOR EXPOSED MASONRY INSTALLATION

### Size range

Modular dimension, 1-leaf:

Width: 625 – 1350 mm

Height: 1750 – 2500 mm

Modular dimension, 2-leaf:

Width: 1,375 – 2,500 mm

Height: 1750 – 2500 mm

### Installation in

- Masonry, min. 175 mm
- Concrete, min. 140 mm
- Autoclaved aerated concrete, min. 175 mm

### Door leaf

- Standard opening outwards
- Double-skinned, rebated on three sides (thin rebate) with weatherboard
- Door leaf thickness: 62 mm
- Panel thickness: 0.75 mm
- Security bolt: at least 3

### Surface

Door leaf and frame galvanised, powder-coated and primed; grey white like RAL 9002

### Special surface equipment

RAL of your choice

### Frame

- Corner frame, 1.5 mm thick with 3-leaf circumferential seal and lower floor bracket
- Frame attached with exposed masonry installation

### Special frame equipment

Counter frame, U frame or block frame

### Special equipment

- Prepared for escutcheon hardware
- Top door closer as per EN 1154
- Retractable bottom seal
- Electric door openers
- Electromechanical blocking device
- Multiple locking device



**Fire-proof**  
as per EN 1634-1  
(DIN 4102)



**Use in outdoor walls**  
CE labelling as per EN  
14351-1



**Sound-insulated**  
as per EN 10140/  
EN 717-1 up to  
RW 33 dB<sup>1)</sup>

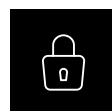

**Burglary-resistant**  
according to DIN EN  
1627, RC 2



**ATEX**  
Directive  
2014/34/EU<sup>1)</sup>

**TECKENTRUP**  
DOOR SOLUTIONS



# FIRE-PROOF DOOR

## T90-1/2-FSA "TECKENTRUP DF"

- 1- AND 2-LEAF
- THICK REBATE
- ALSO IN STAINLESS STEEL
- FOR INDOOR USE

### Size range

Modular dimension, 1-leaf:

Width: 625 – 1500 mm  
Height: 1 750 - 3 500 mm

Modular dimension, 2-leaf:

Width: 1,375 – 3,250 mm  
Height: 1 750 - 3 500 mm

### Installation in

- Masonry, min. 175 mm
- Concrete, min. 140 mm
- Lightweight construction stud wall<sup>2)</sup>, min. 100 mm
- Autoclaved aerated concrete, min. 200 mm

### Door leaf

- Double-skinned, rebated on 3 sides with thick rebate
- Door leaf thickness: 62 mm
- Panel thickness: 1.0 mm/1.5 mm
- Security bolt: per leaf at least 1

### Surface

Door leaf and frame galvanised, powder-coated and primed; grey white like RAL 9002

### Frame

- Corner frame, 2.0 mm (3.0 mm) thick with 3-leaf seal and lower floor bracket

### Special frame equipment

Counter frame, U frame or block frame

### Glazing

- Fire protection glass F90
- With steel glass retainer strips galvanised and primed, grey white like RAL 9002
- Max. pane dimensions 740 x 2,005 mm
- Round glazing Ø 300, 400, 500

### Special glazing equipment

- Steel glass retainer strips with additional aluminium cover strips
- Round glazing - glass retainer strips made from stainless steel

### Special equipment

- Top door closer as per EN 1154
- Locks (panic locks)
- Panic bar handle
- Swing door drives



**Fire-proof**  
as per EN 1634-1  
(DIN 4102)



**Smoke-proof**  
as per EN 1634-3/  
DIN 18095<sup>1)</sup>

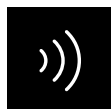

**Sound-insulated**  
as per EN 10140/  
EN 717-1 up to  
RW 44 dB<sup>1)</sup>



**Burglary-resistant**  
according to DIN EN  
1627, WK 2, WK 3<sup>1)</sup>



**ATEX**  
Directive  
2014/34/EU<sup>1)</sup>

**TECKENTRUP**  
DOOR SOLUTIONS

# TECKENTRUP

# SMOKE PROTECTION DOORS

Smoke creation is a hazard to life. Inhaling even small quantities can result in unconsciousness. Good that our smoke protection doors are ever more frequently being used in both private and public development projects.

Our smoke protection doors are tested in accordance with EN 1634-3, have been issued building authority test certificates in accordance with DIN 18095-1 (only RS-1/2-62), and satisfy the requirements of future European standard specifications: S200 according to EN 13501-2. If a fire breaks out in a room, the smoke protection doors tested in accordance with DIN 18095 are automatically closed by door closers. A special seal on three sides and the floor seal adapted to the particular application reliably protect against the penetration of smoke.

## Uses:

- Detached houses
- Residential facilities
- schools
- Clinics
- Cinemas
- Industrial facilities
- Offices
- Large garages







Smoke-proof according to  
EN 1634-3/DIN 18095





# SMOKE PROTECTION DOOR

## RS-1/2 'TECKENTRUP 62'

- 1- AND 2-LEAF
- WITH THIN REBATE
- OPTIONALLY WITH GLAZING

### Size range

Modular dimension, 1-leaf:

Width: 625 – 1350 mm  
Height: 1750 – 2500 mm

Modular dimension, 2-leaf:

Width: 1375 – 2,500 mm  
Height: 1750 – 2500 mm

### Installation in

- Masonry, min. 115 mm
- Concrete, min. 100 mm
- Lightweight construction stud wall<sup>2)</sup>, min. 100 mm
- Autoclaved aerated concrete, min. 115 mm

### Door leaf

- Double-leaf
- 3-leaf rebated (thin rebate)
- Door leaf thickness: 62 mm
- Panel thickness: 1.0 mm
- Security bolt: at least 1

### Surface

Door leaf and frame galvanised, powder-coated and primed; grey white like RAL 9002

### Frame

- Corner frame, 1.5 mm thick with 3-leaf seal and lower threshold for sliding threshold in door leaf
- Frame attached with exposed masonry installation

### Special frame equipment

Counter frame, U frame or block frame

### Glazing

- Standard: rectangular - with aluminium glass retainer strips and VSG glazing
- Max. pane dimensions 741 x 1,658 mm
- Round glazing with steel glass retainer strips, VSG glazing
- Round glazing Ø 300, 400, 500 mm

### Special equipment

- Prepared for escutcheon hardware
- Top door closer as per EN 1154
- Locks (panic locks)
- Panic bar handle
- Retractable bottom seal



**Smoke-proof**  
as per EN 1634-3/  
DIN 18095<sup>1)</sup>

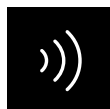

**Sound-insulated**  
as per EN 10140/  
EN 717-1 up to  
RW 38 dB<sup>1)</sup>



**Burglary-resistant**  
according to  
DIN EN 1627,  
RC 2 – RC 3



**ATEX**  
Directive  
2014/34/EU<sup>1)</sup>

**TECKENTRUP**  
DOOR SOLUTIONS





# GREAT DESIGN APPEARANCE

A wide variety of colours and surfaces, hinges, door handles, and glazing variants provide ample leeway for the visual design. Choose from a large selection of door handles that match the overall concept. Together with our 3D hinges, the flushness of the cable channels, the concealed frame, and the stainless steel material, the result is an aesthetically pleasing overall impression that appears to have come from a mould.

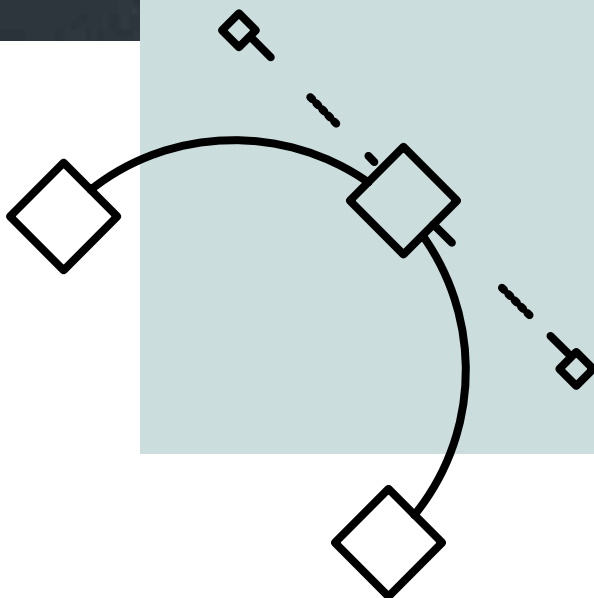



# ALWAYS MATCHES YOUR TASTE

Teckentrup fire and smoke protection doors are delivered with a primer coating in grey-white, similar to RAL 9002. Optional are powder end coatings in accordance with RAL colour map or wooden decorations (technical clarification required).



## SPECIAL ACCENT WITH STAINLESS STEEL

Stainless steel doors are especially dazzling. The representative patterns, matching lever handle sets and handles create a modern, aesthetic room design. Stainless steel doors are also used in areas with special hygienic requirements.



Stainless steel,  
polished  
(240er core)

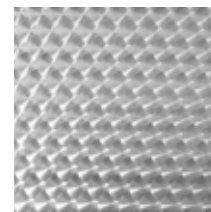

Stainless steel,  
circle-polished  
(marbled)



## GLAZING OPTIONS FOR BRIGHT MOMENTS

Depending on approvals, the application, and function, doors can be provided with glazing in various shapes, glass qualities, and frame materials. Additional shapes and arrangements available per the valid price list or upon request.



Glazing with steel frame, optionally in stainless steel



Glazing with aluminium frame



Glazing with aluminium frame with stainless steel appearance



Round glazing in stainless steel



## DOOR HANDLE

Attractive latch and handle sets made of plastic, aluminium, and stainless steel meet all requirements of function and ergonomics. Here you can find a selection of the available fittings.

**Handle fittings and change sets** in short and long plate versions



**Round handle fitting, short plate,**  
aluminium



**Round change set, short plate,**  
aluminium



**Round handle fitting, short plate,**  
aluminium



**Round handle fitting, long plate,**  
aluminium



**lever and lever/knob handle set with escutcheon**



---

**Round handle fitting, escutcheon, aluminium**



---

**Round lever/knob handle set, escutcheon, aluminium**



---

**Round handle fitting, escutcheon, stainless steel**



---

**Round lever/knob handle set, escutcheon, stainless steel**

**ES 1 security fittings for RC2 doors or ES 3 for RC3 doors in accordance with EN 1627**



---

**Security lever handle set Class ES 1 per DIN 18257, aluminium**



---

**Security lever handle set Class ES 1 per, aluminium**



---

**Security lever handle set Class ES 3 per, aluminium**

# GREATEST SAFETY FOR MANY APPLICATIONS

The numerous safety functions of project doors are guaranteed with various door closers, arresting devices, drives, anti-panic equipment, etc. The door leaf and frame provide the basis for a long-lasting door element. However, it is only complete with high-quality fittings and electrical equipment which implement current requirements on reliable function with an integrated system.

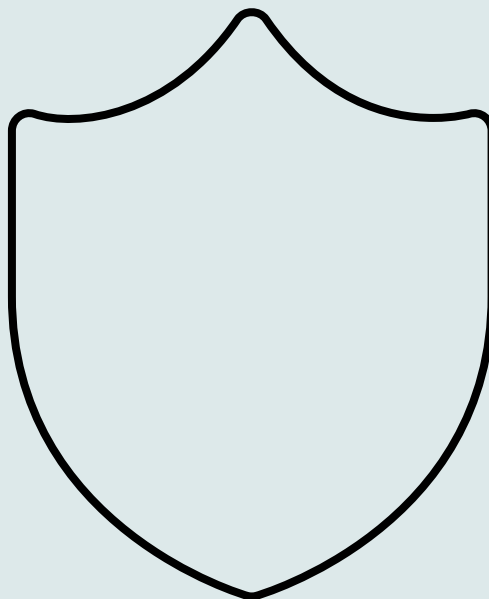



# LAYER FOR LAYER QUALITY

Safety, durability, aesthetics – the same requirements also apply for the surfaces of our products.

- a** Internal core depending on application
- b** 2-component industrial adhesive
- c** Anti-corrosion galvanisation
- d** High-strength steel
- e** Anti-corrosion galvanisation
- f** Door leaf and frame primer similar to RAL 9002
- g** Powder-coating finish (optional)



**a**

**b**

**c**

**d**

**e**

**f**

**g**



## PANIC LOCK

Automatically locking  
anti-panic lock with  
A panic bar handle  
in accordance with DIN 1125,

In the case of an emergency, users must be able to exit the building as quickly as possible. Therefore, it must always be possible to open doors in escape routes. On request, we equip our project doors with locks and fittings for emergency exits in accordance with DIN EN 179 or for escape routes in accordance with DIN EN 1125. Therefore, a safe exit is always guaranteed - even if the doors are locked. Here, panic handle and push bar provide the safest solution because they unlock automatically when physical pressure is applied to the door.

## LOCK AND ESCAPE ROUTE TECHNOLOGY

Our locks and locking systems will impress you with the highest level of quality and permanent reliability.



Automatically locking anti-panic locks can also be equipped with multi-point locks.



Push bar: It enables the opening of the door by gently pushing on the release surface.



Standard lock: Mortice lock with knob, perforated profile. Alternatively, other locks such as an additional bolt switching lock or motor lock can also be used.

## HINGES AND SECURITY BOLTS

Our doors receive sturdy construction hinges with ball bearings. Flush-closing doors can also be equipped with the completely concealed Tectus hinge system on request.



**3D hinge - refinement and functionality:** For improved installation friendliness, we offer flexible 3D hinges for our project doors. They are an innovation which enables subsequent adjustment of the door leaf in 3 directions. This enables problem-free compensation of small tolerances. The 3D hinges are available in galvanised and stainless steel versions.



**Construction hinge:** Construction hinges with ball bearings guarantee that opening and closing the door will always be easy. The hinges are integrated in the door leaf and thus have no influence on the visual appearance of the door leaf surface. The door height can be subsequently adjusted with the supplied hinge hook rings up to 4 mm.



**Concealed hinge:** We offer optional integrated hinges (Tectus) for our flush-closing doors. In this case, the hinges are concealed in the door leaf and/or the frame rebate.



**Security bolts:** When the door is closed, they protrude into the frame and provide additional protection against forced entry.



## ELECTRICAL ATTACHMENTS

Doors with electrical systems are frequently interconnected. This includes escape routes and alarm technology as well as motor and block locks, for example. The overall look of our building doors is not affected by the concealed cable conduit.



**Concealed cable access:** Doors with electrical systems are frequently interconnected. This includes escape routes and alarm technology as well as motor and block locks, for example. The overall look of our building doors is not affected by the concealed cable conduit.



**Electric strikes / Door drive:** The door opener can be used to access the building remotely (2-leaf doors also). Swing door drives provide added comfort and ease of operation, e.g. in hospitals, retirement homes, etc.



**Concealed magnetic contact:** With its concealed installation in the frame and door leaf, the magnetic contact reports when the door is closed and/or open.



**Escape door terminal:** Safely locked in everyday use while allowing quick and easy opening in the case of an emergency. These are the most important requirements for doors in escape and emergency routes. Electronic escape route securing systems assist in fulfilling these apparently contradictory requirements.

## DOOR CLOSERS

Doors can be closed automatically with door closers, even for fire and smoke protection doors. They are also available with arresting systems or free-wheel function.



Slide rail door closer: silver colour (standard), also available in stainless steel look or RAL colours upon request



Scissor closer (standard): silver (standard), also available in stainless steel look or RAL colours upon request



TDC 35 slide rail closer: Cost-neutral alternative to the scissor closer for many doors.



## INTEGRATED DOOR CLOSERS

A must for aesthetics: a door closer that is completely integrated in the door leaf and thus invisible when the door is closed. Integrated door closers compliment the concealed Tectus hinges.

# CORNER FRAME

Corner frame for 62er doors, wall plug assembly

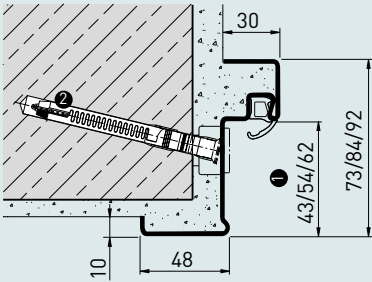

1. Depends on door leaf thickness and rebate construction
2. Installation with frame anchor possible (excluded T60, T90)

Quick and concealed installation with adjustable screws and only one fastening point.



Corner frame for 42 mm doors, wall plug assembly (masonry/concrete)

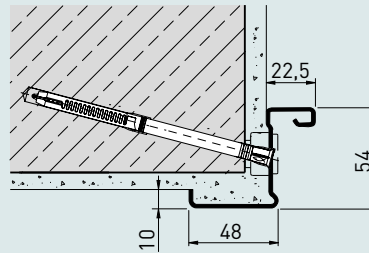

Wall anchor, dowelled, (masonry/concrete)

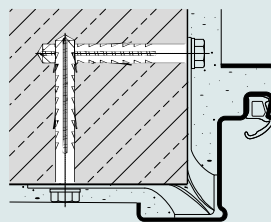

Wall anchor, mortared, (masonry/concrete)

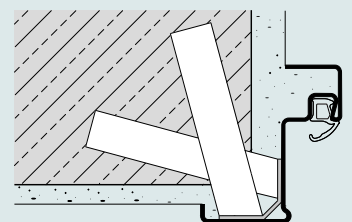

Weld installation with sliding anchor (exposed masonry)

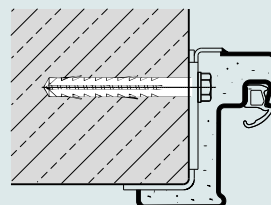

Wall plug installation (aerated concrete)

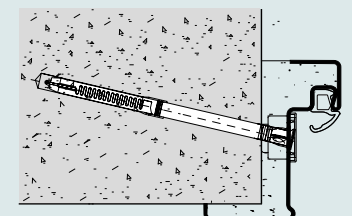

## TSM CORNER FRAME - DRY, QUICK ASSEMBLY

Mortar-free wall plug assembly  
(masonry/concrete)

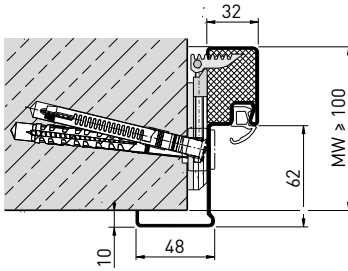

- MORTAR-FREE FRAME FASTENING
- READY-TO-ASSEMBLE SYSTEM
- OPTIONALLY ALSO IN REVEAL DEPTH



- Frame factory infill with mineral wool
- No time-consuming grouting - no mess
- Complete installation in one step
- Simple fixing of the frame with a special frame anchor
- Improvement of the overall appearance with concealed fastening
- Ready-to-install frame also suitable for retroactive installation in a finished wall

# CORNER/COUNTER FRAME

Corner/counter frame for 62 mm doors  
Wall plug installation with slide anchor  
(masonry/concrete)

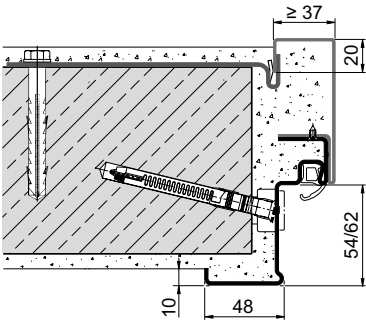

Depends on door leaf thickness and rebate construction

Corner/counter frame for 42 mm doors  
Wall plug installation with slide anchor  
(masonry/concrete)

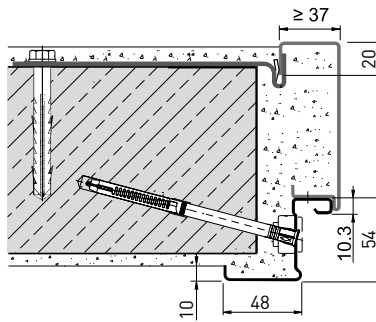

Wall anchor, dowelled with slide anchors  
(masonry/concrete)

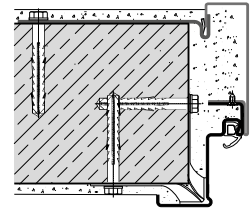

Wall plug and hinged anchor installation (masonry/concrete)

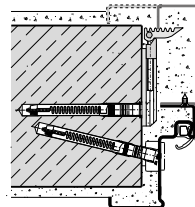

Wall plug and hinged anchor installation (exposed masonry/autoclaved aerated concrete walls)

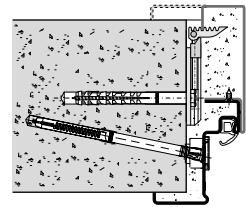

Concealed installation of the counter frame with special fold anchor



Weld installation with anchor bracket (autoclaved aerated concrete walls)

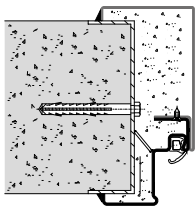

Countersunk screw fastening (lightweight partition)

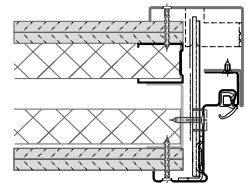

# CIRCUMFERENTIAL FRAME

Wall plug with slide anchor (masonry / concrete)

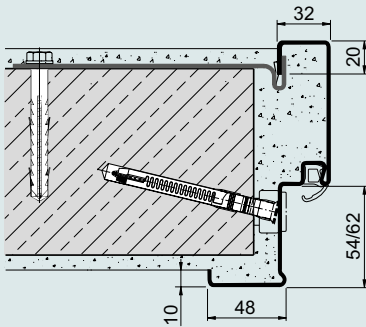

Wall anchor, dowelled with slide anchors (masonry/ concrete)

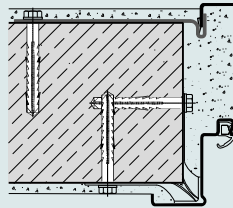

Wall plug and hinged anchor installation (masonry/concrete)

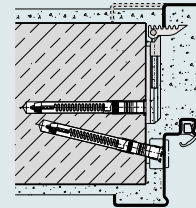

Depending on door leaf thickness and rebate design

Quick and concealed installation of the closed frame using adjusting screws and slide anchors.

Wall plug and hinged anchor installation (exposed masonry/autoclaved aerated concrete walls)

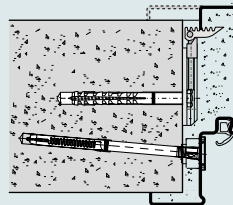

Weld installation with anchor bracket (autoclaved aerated concrete walls)

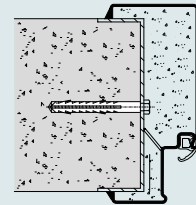

Countersunk screw attachment ( lightweight construction stud wall)

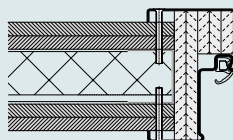

## BLOCK FRAME

Type 4.1 Wall plug assembly with plaster filling (masonry/autoclaved aerated concrete)

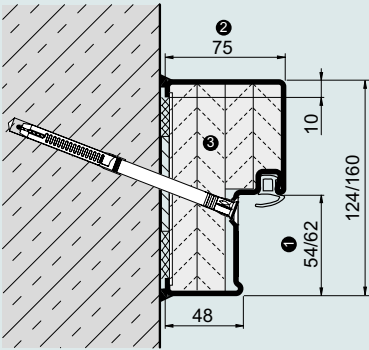

1. Depends on door leaf thickness and rebate construction
2. For block frame Type 4.2 = 100 mm
3. Factory infill optional

Quick and easy installation of a block frame Type 4.1 with factory infill



Type 2.2 Concealed wall plug assembly in front of opening (masonry/concrete),

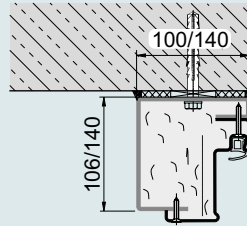

On-site screw-mounting and optional factory infill

Type 2.3 Concealed wall plug assembly in opening (masonry/autoclaved aerated concrete)

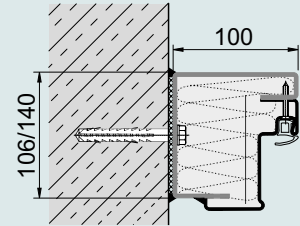

Factory pre-installed and optional factory infill

Type 5.1 Wall plug assembly in front of opening (masonry/concrete),

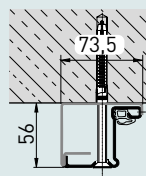

Type 5.3 / 5.3 L Wall plug assembly in the opening (masonry/concrete/steel beams)

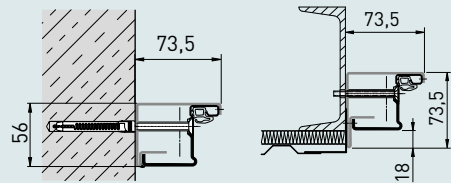

Version for single- and double-leaf Multi-purpose doors Teckentrup dw 42-1/2, optional factory infill



# BOTTOM SEAL

## Sliding threshold

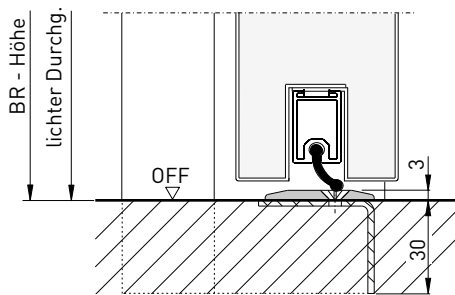

## Buffer seal

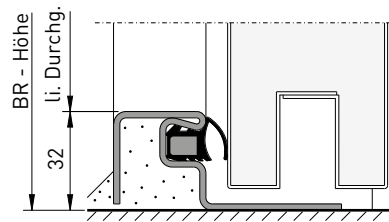

## Retractable bottom seal

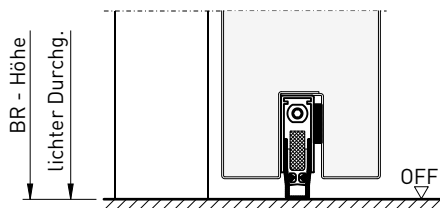

## Double retractable bottom sea (for highly sound-insulated doors)

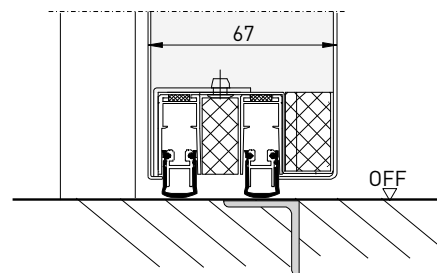

## Double sliding threshold and bottom profile (for high sound-insulated doors)

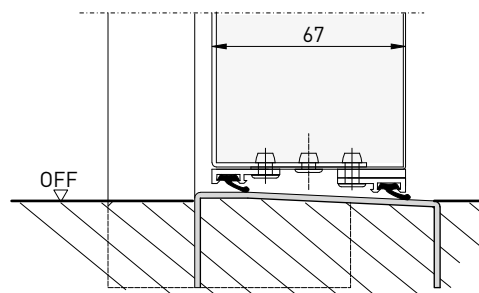

Main qualification		Fire-resistant T30									
DOOR NAME		HT 8-D	FSA 42		FSA 62 (thick rebate)		FSA 62		FSA 62 AE		FSA 62 ST
Number of leaves		Single-leaf	Single-leaf	Double-leaf	Single-leaf	Double-leaf	Single-leaf	Double-leaf	Single-leaf	Double-leaf	Single-leaf
Product on pages		14.	16.	16.	20.	20.	22.	22.	24.	24.	26.
ADDITIONAL QUALIFICATIONS, STANDARD											
Heat insulation		1.5.	1.5.	1.7.	1.3.	1.4.	1.3.	1.4.	1.3.	1.4.	-
ADDITIONAL QUALIFICATIONS WITH APPROPRIATE EQUIPMENT											
Smoke protection		■	■	■	■	■	■	■	-	-	■
Sound insulation (dB)		37 – 39	38 – 40	38 – 40	39.	38.	44.	37 – 38	33.	33.	34 – 35
Anti-burglary characteristics		WK 2	WK 2	-	RC 2 – 3	RC 2 – 3	RC 2 – 4	RC 2 – 4	RC 2	RC 2	RC 2
ATEX		■	■	■	■	■	■	■	■	■	■
DOOR LEAF											
Leaf thickness (mm)		42.	42.	42.	62.	62.	62.	62.	62.	62.	62.
Panel thickness (mm)	primed	0.9.	1.0.	1.0.	1.0/1.5	1.0/1.5	1.0/1.5	1.0/1.5	0.75.	0.75.	1.0.
	Stainless steel	-	-	-	1.0.	1.0.	1.0.	1.0.	-	-	1.0.
Rebate	Thin rebate	■	■	■	-	-	■	■	■	■	-
	Thick rebate	-	-	-	■	■	-	-	-	-	-
	flush	-	-	-	-	-	-	-	-	-	■
Glazing possible		-	-	-	■	■	■	■	-	-	■
Upper casing/top light possible		-	-	-	■	■	■	■	-	-	-
FRAME VARIANTS											
Corner frame		■	■	■	■	■	■	■	■	■	■
Counter frame		■	■	■	■	■	■	■	■	■	■
Closed frame		-	■	■	■	■	■	■	■	■	■
Block frame		-	■	■	■	■	■	■	■	■	■
INSTALLATION IN											
Masonry		■	■	■	■	■	■	■	■	■	■
Concrete		■	■	■	■	■	■	■	■	■	■
Aerated concrete		-	■	■	■	■	■	■	■	■	■
Lightweight partition		-	■	■	■	■	■	■	-	-	■
Clad wooden supports		-	■	■	■	■	■	■	-	-	■
BASIC DIMENSION (MM)											
Width	minimum	750.	625.	1375	500.	1375	500.	1375	625.	1375	625.
	maximum	1125	1125	2250	1500	3000	1500	3000	1350	2500	1250
Height	minimum	800.	1750	1750	500.	1750	500.	1750	1750	1750	1750
	maximum	2125	2250	2250	3500	3500	4000	4000	2500	2500	2500
Max. total height with upper casing		-	-	-	3750	3750	4600	4600	-	-	-

			Highly fire-resistant T60		Fire-proof T90						Smoke-proof	
FSA GL			FSA 62		FSA 62		FSA 62 AE		FSA DF		RS-1/2	
Double-leaf	Single-leaf	Double-leaf	Single-leaf	Double-leaf	Single-leaf	Double-leaf	Single-leaf	Double-leaf	Single-leaf	Double-leaf	Single-leaf	Double-leaf
26.	30.	30.	32.	32.	34.	34.	36.	36.	38.	38.	42.	42.
-	-	-	1.3.	1.4.	1.3.	1.4.	1.3.	1.4.	-	-	1.3.	1.4.
-	■	■	■	■	■	■	-	-	■	■	■	■
36.	34.	-	33.	33.	33-42	33.	33.	33.	41-44	36-40	35-37	37-38
RC 2	-	-	RC 2-3	RC 2-3	RC 2-4	RC 2-4	RC 2	RC 2	WK 2-3	-	RC 2-3	RC 2-3
■	■	■	■	■	■	■	■	■	■	■	■	■
62.	27.	27.	62.	62.	62.	62.	62.	62.	62/64	62/64	62.	62.
1.0.	-	-	1.0.	1.0.	0.75/1/1.5	1.0/1.5	0.75.	0.75.	1.0/1.5	1.0/1.5	1.0.	1.0.
1.0.	-	-	1.0.	1.0.	1.0.	1.0.	-	-	1.0.	1.0.	-	-
-	-	-	■	■	■	■	■	■	-	-	■	■
-	-	-	-	-	-	-	-	-	■	■	-	-
■	■	■	-	-	-	-	-	-	-	-	-	-
■	-	-	■	-	■	■	-	-	■	■	■	■
-	-	-	-	-	■	■	-	-	-	-	-	-
■	■	■	■	■	■	■	■	■	■	■	■	■
■	■	■	■	■	■	■	■	■	■	■	■	■
■	■	■	■	■	■	■	■	■	■	■	■	■
■	■	-	■	■	■	■	-	-	■	■	■	■
■	-	-	-	-	-	-	-	-	-	-	■	■
1375	625.	1375	625.	1375	500.	1375	625.	1375	625.	1375	625.	1375
2500	1250	2500	1250	2500	1500	3000	1350	2500	1500	3250	1350	2500
1750	1750	1750	650.	1750	500.	1750	1750	1750	1750	1750	1750	1750
2500	2500	2500	2500	2500	3000	3000	2500	2500	3500	3500	2500	2500
-	-	-	-	-	4000	4000	-	-	-	-	-	-



DESIGN | SECURITY | SERVICE

Professional solutions

We provide customised solutions for your individual requirements. With our fire and smoke protection doors, you can count on more design, security and service.



AUB Limited  
Unit A, 12/F,  
Hung Mou Industrial Building,  
62 Hung To Road, Kwun Tong,  
Kowloon, Hong Kong  
Tel : +852 2375 6110  
Fax : +852 2406 2602  
enquiry@aub.com.hk  
www.aub.com.hk

**TECKENTRUP**  
DOOR SOLUTIONS