



Security guardhouses

Highly secure – modular – individual



Protecting lives and property. Worldwide.

www.saelzer-security.com



SÄLZER security guardhouses – the concept

Increasingly complex threat scenarios involving criminal, terrorist or even industrial disruptions and accidents nowadays require integrated security planning utilising reliable and often multifunctional products. SÄLZER guardhouses guarantee the protection of people and property against the most diverse types of attack and threat. They consist of a flexible, modular system, comprising components that can be freely combined depending on the requirements.

The flexible design of the outer shell with windows and doors in different security classes and for different types of threat allows

SÄLZER guardhouses to guarantee proven security against forced entry, bullets and explosions. The modular prefabrication means that, once the foundations have been laid, the turn-key guardhouses can be constructed on site and ready for use in just a few days, offering the desired level of security right from the start. There are no limits to creative freedom where these products are concerned: the range of system versions offer something for every possible design style – modern and minimalist, traditional and elegant, or historic with listed building requirements.

Tested and certified protection concepts

The unwavering core requirement of all SÄLZER products is: maximum security. This also applies to all SÄLZER guardhouses. The entire guardhouse is produced in the desired resistance class in compliance with national and international standards and in accordance with individual customer requirements. The product tests were performed by recognised test institutes and documented by certificates.

Tested and certified security



Forced entry resistance

According DIN EN 1627-1630 **up to RC 5** (RC 6 for steel elements and fixed windows).

Glazing according to DIN EN 356.



Bullet resistance

According DIN EN 1522-1523 **up to FB7-NS.**

Glazing according to DIN EN 1063.



Blast resistance

According DIN EN 13123-2 **up to EXR3** (12 kg|5,5 m).
In open range tests: with explosive loads such as **100 kg, 250 kg, 500 kg** and tests according to individual customer requirements.

Test example:

100 kg TNT, 10 m distance,
reflected pressure **880 kPa** |
reflected impulse **1.543 kPa-msec.**

Glazing according to SÄLZER specification.

Classified:

GSA 2 (Protection Level, „Very High“),
ISO B (Hazard-Rating, „No Hazard“).

Industry-sector-specific tests e.g.

for the petrochemical industry, peak pressure $p_{max} = 134 \text{ kPa}$, pressure duration $t_p > 2 \text{ sec.}$

The complete guardhouse is also available according the standard of the **US-Dep. of State**, SD-STD-01.01 Rev G, certified in **5 FE and 15 FE/BR.**

For special application in crisis areas SÄLZER offers special elements tested according to **NATO STANAG 2280 up to class C5** (artillery shell, calibre 133 mm, weight approx. 43 kg, distance 1,5 m)

For special applications

Fire resistance, gas-tightness and further individual requirements on request.





SÄLZER security guardhouses – the benefits at a glance

The modular yet individual construction method, the specific adaptations to local conditions and the rapid on-site installation are just a few of the benefits that make SÄLZER guardhouses unique:

- › Everything from a single source: consultation, planning, production, installation and maintenance
- › Combined security: protection against forced entry, bullets and explosions up to the highest available classes can be combined in a variety of ways
- › Flexible application: suitable for temporary use as a mobile guardhouse or as a fixed solution
- › Flexible guardhouse sizes depending on individual customer specifications
- › The torsion-resistant construction allows the delivery as a complete unit, worldwide
- › A wide range of design options
- › Made in Germany: identical level of quality throughout the world due to production at the Marburg-based factory and installation on site by experienced SÄLZER engineers
- › On request, customers can check the guardhouse before delivery
- › Full cost control through turn-key complete delivery





SÄLZER security guardhouses – the complete package

Basic concept, dimensions and transport

The individual modules of the SÄLZER guardhouses are based on a self-supporting frame construction made from steel profiles. Building on this basic construction, the SÄLZER experts individually design and produce the guardhouses, tailored to the customer's requirements and the respective area of use. The size and features of the individual modules, and thus the entire guardhouse, depend on the answers to questions like: How many people work in the guardhouse? Is a control room required? Does the customer require bathroom and/or kitchen facilities? Will sleeping and/or storage rooms be needed? Should other functional spaces be included in the design?

As a general rule, the customer determines the size and features of the guardhouse. There are no limits on the size of a finished guardhouse – only the permissible road transport width can restrict this. The modular construction also offers the perfect solution in this regard: the floor area of each guardhouse can be individually enlarged on site by attaching multiple modules. The torsion-resistant construction ensures that there are no issues during transportation and routine installation at the specified site, as well as during dismantling and re-construction at another location.



For easy and cost-effective transport worldwide by container, SÄLZER offers the guardhouses in the standard sizes of 10, 20 and 40 feet.

Individual design examples:

- › **Guard room**
- › **Control room for the entrance and exit control with two interlocking doors, optional equipment such as turnstile, metal detectors and body scanners**
- › **Technical facilities, e.g. server rooms, emergency power supply**
- › **Communal room**
- › **Sanitary facilities**
- › **Kitchen facilities**

In addition to the high level of protection they offer, SÄLZER security guardhouses fulfil all of the required structural performance properties:



thermal insulation



resistance to wind load



watertightness



impact resistance



sound reduction



air permeability

SÄLZER security guardhouses – examples

Module sizes and combination options

The following guardhouses are examples of the different sizes and features. As a general rule, the number of modules, the size, the spatial division, interior design, the design and the security concepts are all flexible. Irrespective of their size, all guardhouses can be fitted with individual combinations of security systems for protection against forced entry, bullets and/or explosions. They are thermally insulated in accordance with the current requirements and, if required, can be fitted with electrical, heat and climate control technology.

Small module, one room – for up to 2 people

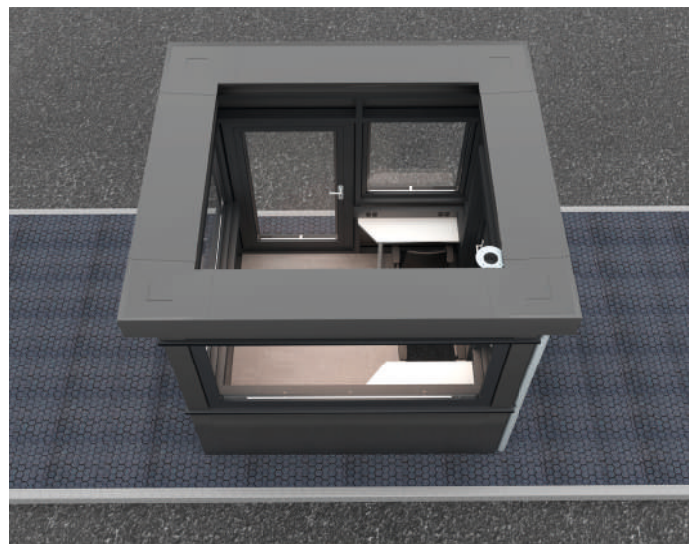
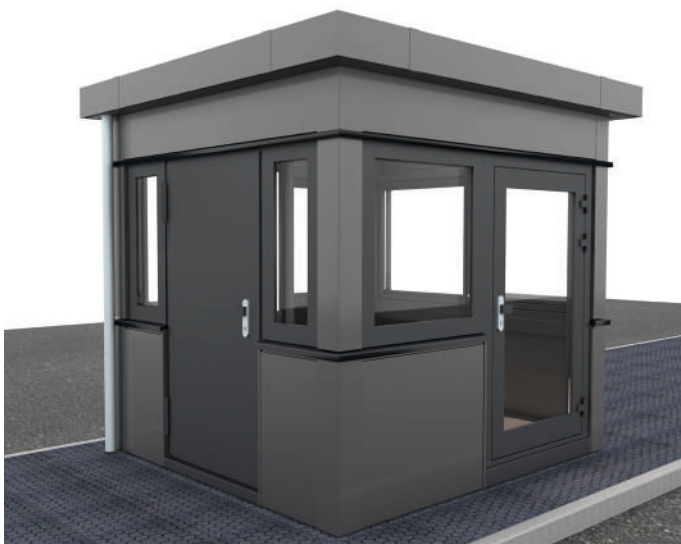

Example use: control of access and entry to public facilities, industrial sites and military bases.

Medium module, 2 rooms – for up to 4 people

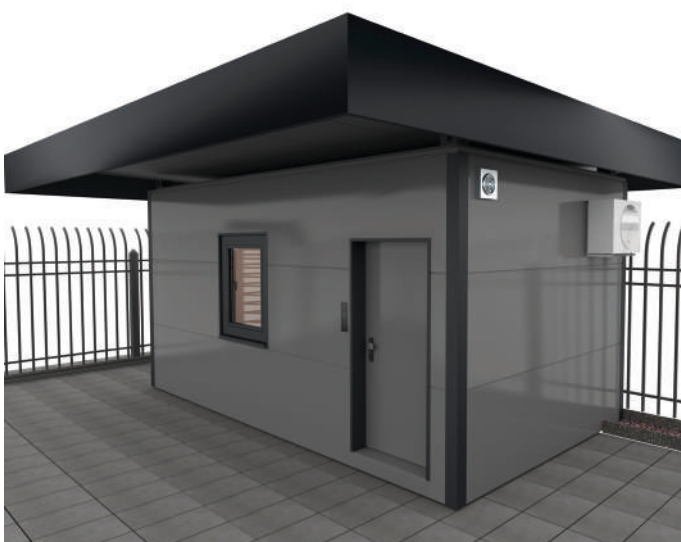

Example of interior design: use of a glazed security partition wall, including a transaction window with transaction drawer and intercoms. The first room is for the guard staff and the second one can be used for performing security checks on individuals.



2 modules, 5 rooms – for larger teams

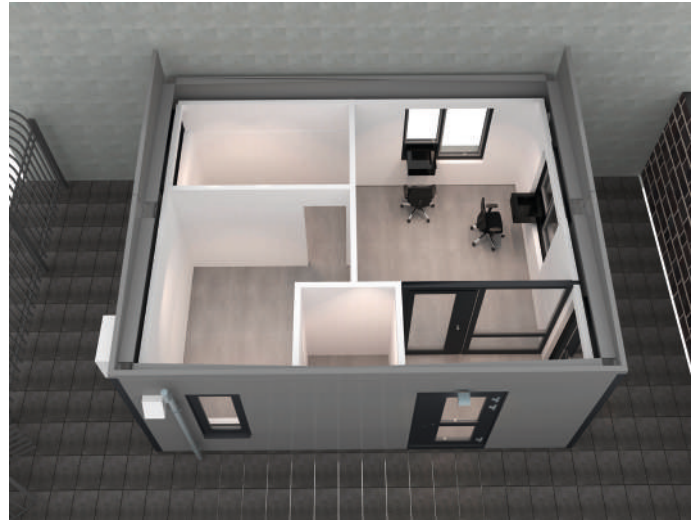

In this example, the guardhouse consists of 2 modules. With a total of 5 rooms (guard room, control room with 2 interlocking doors, technical room, sanitary facility and kitchen area), it is suitable for use by a whole team. As an option, a mono-pitch roof can be installed, with adaptations to suit the local conditions.

» Every SÄLZER guardhouse is as individual as its purpose. All of the combined security units have been issued with hundreds of test certificates and granted intellectual property rights. «

Architecture and interior design

For the basic construction, the rule of thumb is: as many standard options as necessary, but as much individuality as possible.

Maximum security guaranteed. Whether basic, modern, industrial, functional or striking: SÄLZER guardhouses can be adapted to match the design and architecture of existing buildings, or make a design statement as a stand-alone structure – without compromising the high security standards. Generous glazing, profiles with custom colours and materials and a variety of construction types, fittings and design options can make the guardhouse either a stand-out piece or a discreet, functional entrance. All of the required connections for power supplies, telephone lines, water and waste are prepared

in the factory in Marburg – tailored to the country-specific requirements. Individuality and variety also apply to the interior design: the guard room can be fitted with work stations, shelving systems, a kitchen and sanitary facilities. The result is a fully pre-assembled, turn-key, complete unit – with a guarantee for maximum security in accordance with national and international standards, customer-specific design and economical implementation.

Exterior design options

Depending on the specifications from the customer, any of the conventional facade claddings can be used on the exterior, be it aluminium cassette panels, aluminium composite panels or boarding with natural stone, stainless steel or timber – there are no limits to creative freedom. Floor-to-ceiling fully and partially-glazed units can also be installed with ease. All of the building units are certified in each of the resistance classes.

Windows and external doors. The complete SYSTEM SÄLZER® is available for installation: windows with turn, tilt or tilt-turn hardware, as well as fixed windows with a transaction drawer and communication equipment. Aluminium or steel plate doors, fully glazed, with a glass vision panel, glazed top and sidelights.

There are also virtually no restrictions on the **type of roof**: standard options include flat, saddle and hipped roofs, and a cantilevered canopy with any section length can also be integrated.



» The best security is security you can't see.
After all, maximum security and individual
design are not mutually exclusive. «



Interior design options

Wall cladding and internal doors can be constructed in a wide range of materials and designs – plasterboard panels, textile wall coverings or wood-based materials are suitable as wall cladding. Internal doors can either be secured or unsecured. With regard to flooring, you can choose from PVC, tiles, natural stone or carpet, for example.

Heating and cooling are planned and installed in accordance with the geographic and country-specific requirements. Separate control of the heating and cooling technology is easy to implement. The heating system can be connected to the local heating network.

Built-in furniture like work stations, shelves or cabinets made from a range of materials can be fabricated and installed in line with your individual specifications. The kitchen can be fitted with an electric stove, fridge, sink, cupboards and a boiler to supply hot water. A toilet and hand basin with a continuous flow water heater are included in the basic sanitary facilities. The set-up for control unit equipment can be integrated in advance.



SÄLZER security guardhouses – used all over the world

Across the globe, SÄLZER guardhouses provide physical building security for the protection of lives and property.

The SÄLZER USP: the guardhouses are 100% made in Germany. All of the units for the turn-key guardhouse are assembled in the Marburg-based factory. Customers therefore have the guarantee that the products are made exclusively in line with recognised international standards and using high-quality materials. Experienced SÄLZER experts also supervise construction on site: made in Germany for maximum security worldwide.

Installation locations include:

- › **Administrative and government buildings, like embassies, consulates and ministries**
- › **Buildings belonging to international organisations**
- › **Facilities for the police and security staff**
- › **Penal institutions and forensic psychiatric facilities**
- › **Military bases**
- › **Industrial sites, such as petrochemical plants**
- › **Research institutes**
- › **Data processing centres**

From production to the building site – completely installed and ready for use

The SÄLZER range of services for guardhouses includes consultations, planning, production, transport, professional on-site installation worldwide and maintenance, all from a single source. The SÄLZER experts produce the complete guardhouse modules at the company's own production site in Marburg. Factory acceptance test is also possible, offering an additional quality control measure. SÄLZER arranges all aspects of the logistics, including customs clearance. This involves packing the guardhouse modules, organising the transport by HGV, sea or air freight, and carrying out and overseeing transportation from the designated port or airport to the installation location – all while taking into account the respective climate zones.

On the building site, the guardhouse is then ready for use in just a few days. On request, the final installation can be carried out by the SÄLZER installation team, who work across the globe. Alternatively, a supervisor can be dispatched. The many successful projects completed in Europe, Asia, Africa and the Middle East are testament to the expertise of the SÄLZER team.





Security guardhouses for special requirements

Use in crisis zones

For use in crisis and war zones, SÄLZER has developed a guardhouse that provides protection against mortars and artillery shells. It has been certified up to class C5 in accordance with NATO STANAG 2280. In the test, the guardhouse modules resisted the enormous explosive force of the shells, which were detonated close to the units – even large pieces of shrapnel were absorbed.



The construction successfully passed the test with artillery shells (155 mm, approx. 43 kg) that were detonated at a distance of 1.5 m from the unit.

Use as a refuge in the event of accidents

For specific use in refineries, chemical plants, munition factories and other sensitive areas, SÄLZER has developed a guardhouse that fulfils the particular security requirements of the industry.

In addition to forced entry, bullet and explosion resistance, the guardhouse can be designed to be fire-resistant, airtight and smoke-proof, and can be fitted with an air purification system. This special version offers extensive protection for the on-site staff until the emergency services arrive. The guardhouse can be designed as a fixed installation or mobile version for temporary use.



Use in the petrochemical industry.

Security guardhouses for high design standards

One of the SÄLZER maxims is: the best security is security you can't see. After all, maximum security and individual design are not mutually exclusive. The customer therefore determines the design of the guardhouse and SÄLZER then implements the best security technology for this design concept. This means, for example, that generous glazing, even with a conventional construction method, ensures that the guardhouse is individually adapted to the architecture of the entire property.



Generous glazing of the guardhouse for an American property with a sloping double facade and roof construction. All of the components were security-tested in advance in accordance with specifications of the US Department of State.



A fully-glazed, cube-shaped guardhouse for a German Embassy abroad with a security facade made from box profiles and an aluminium add-on construction, which is able to bear the 2+ tonne weight of the 4.6 x 3.2 m individual security glazing with ease.

Security systems for highest expectations – SYSTEM SÄLZER



As part of the Schüco Group with over 6,330 employees worldwide, SÄLZER GmbH is at the very cutting-edge of high-security technology. Our customers worldwide know that they can rely on our high-security windows, doors and façades. These offer combined protection against forced entry, bullet penetration and explosions, especially in the highest security classes. Our primary mission in everything we do is the protection of human life and values.

For more information, visit: www.saelzer-security.com and www.schueco.com

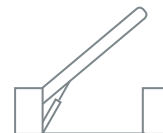

SÄLZER GmbH
Dietrich-Bonhoeffer-Str. 1-3
35037 Marburg, Germany

Switchboard: +49 (0) 6421 938 100
Fax: +49 (0) 6421 938 190
E-Mail: info@saelzer-security.com

Protecting lives and property. Worldwide.

www.saelzer-security.com